

LEGENDA

	GUIA	437,79 m
	SARJETA	14,91 m²
	SARJETÃO	5,18 m²
	DEMOLIÇÃO CONCRETO / ALVENARIA	6,74 m²
	RETIRADA DE CERCA	18,23 m
	RETIRAR	4 unid.
	REMOÇÃO DE ÁRVORES	4 unid.

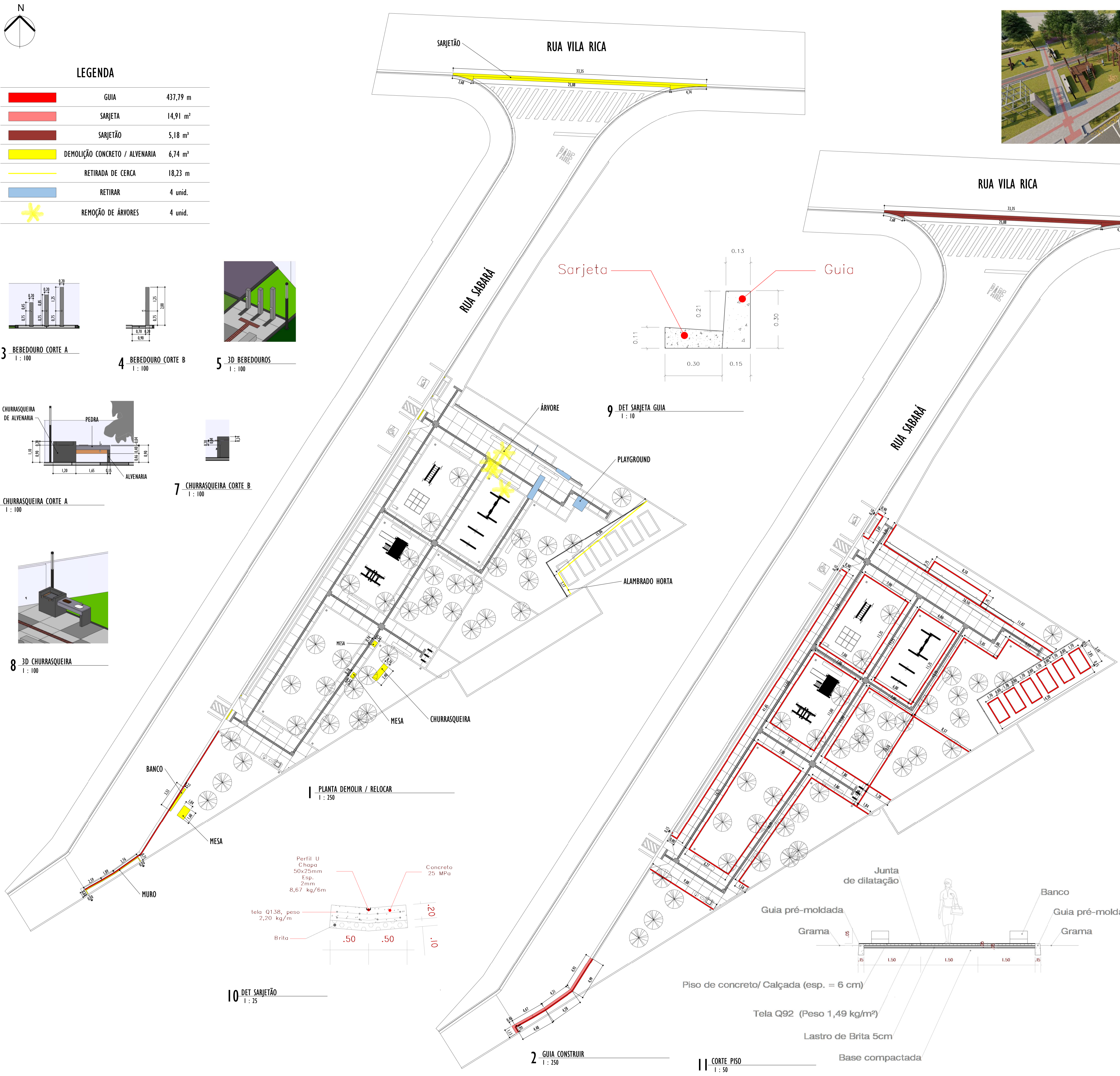

1 PLANTA DEMOLIR / RELOCAR 1:250

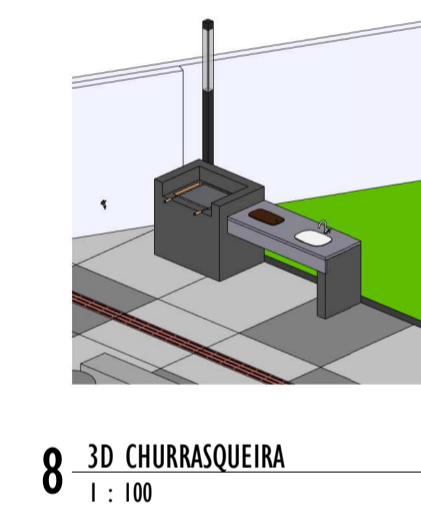
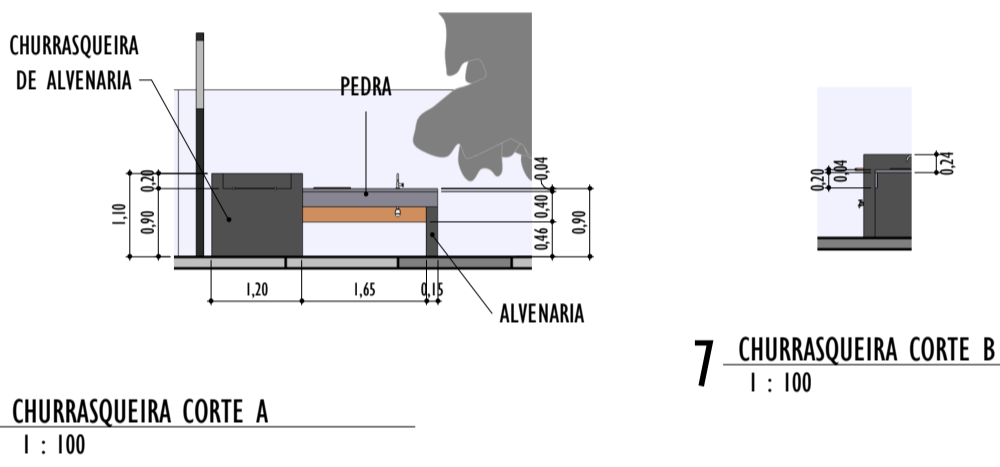
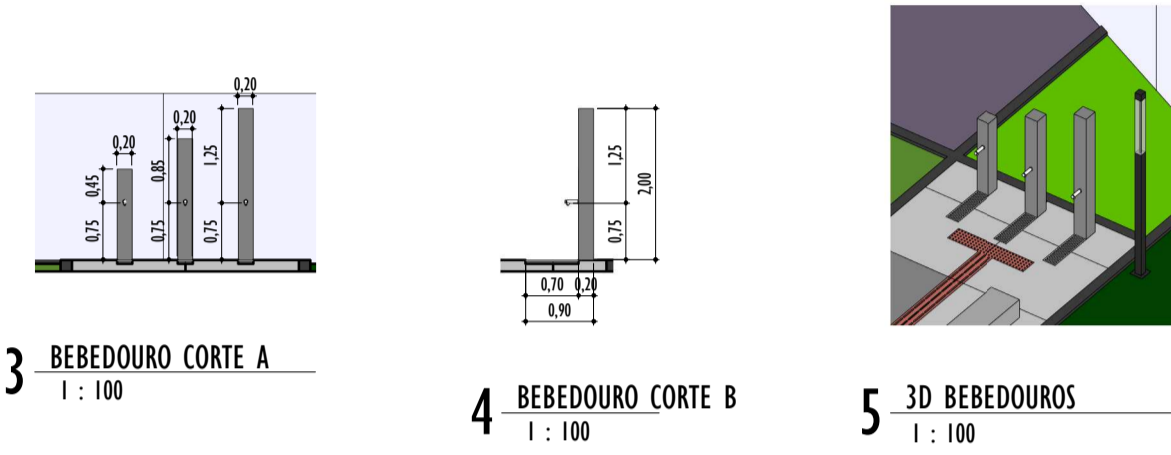
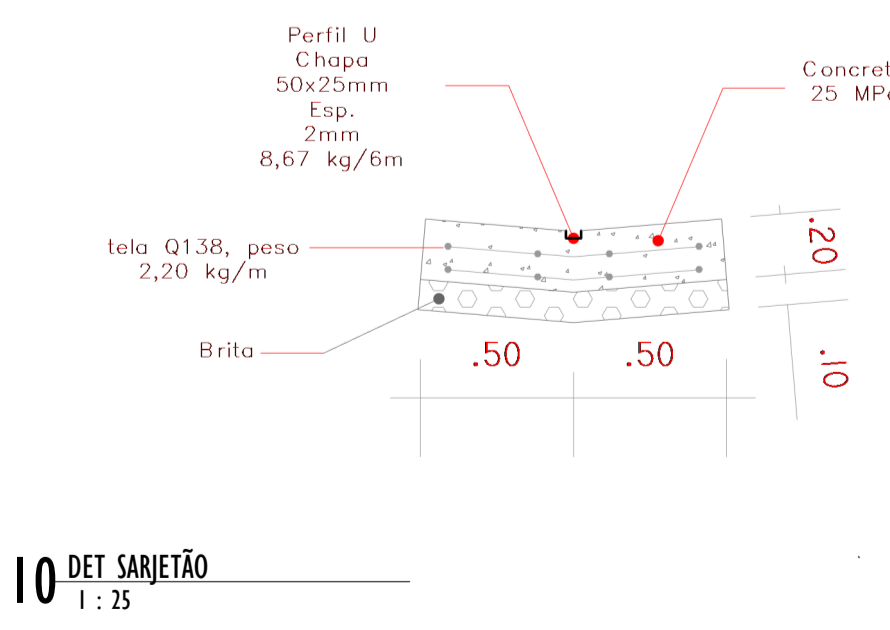

2 GUIA CONSTRUIR 1:250

COORTE PISO 1:50

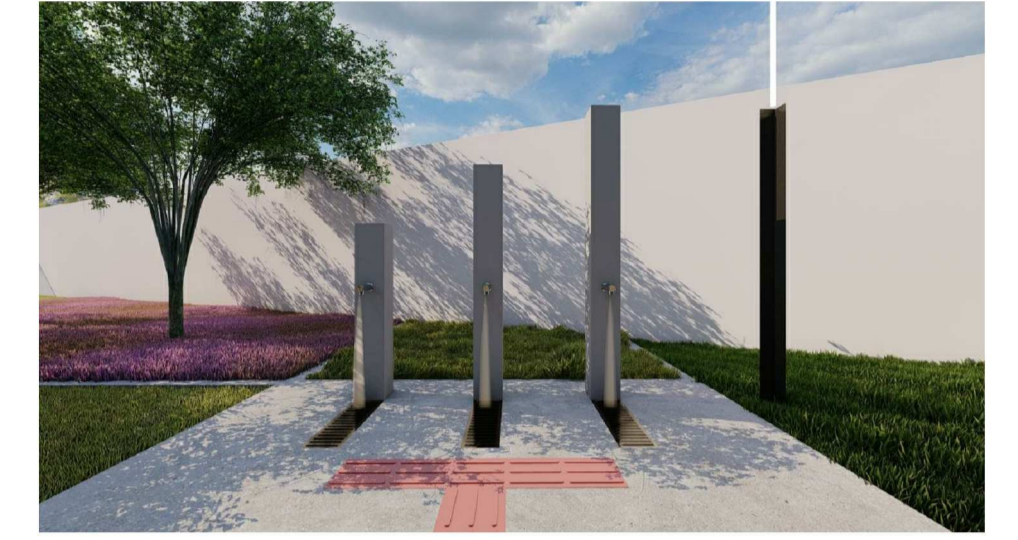
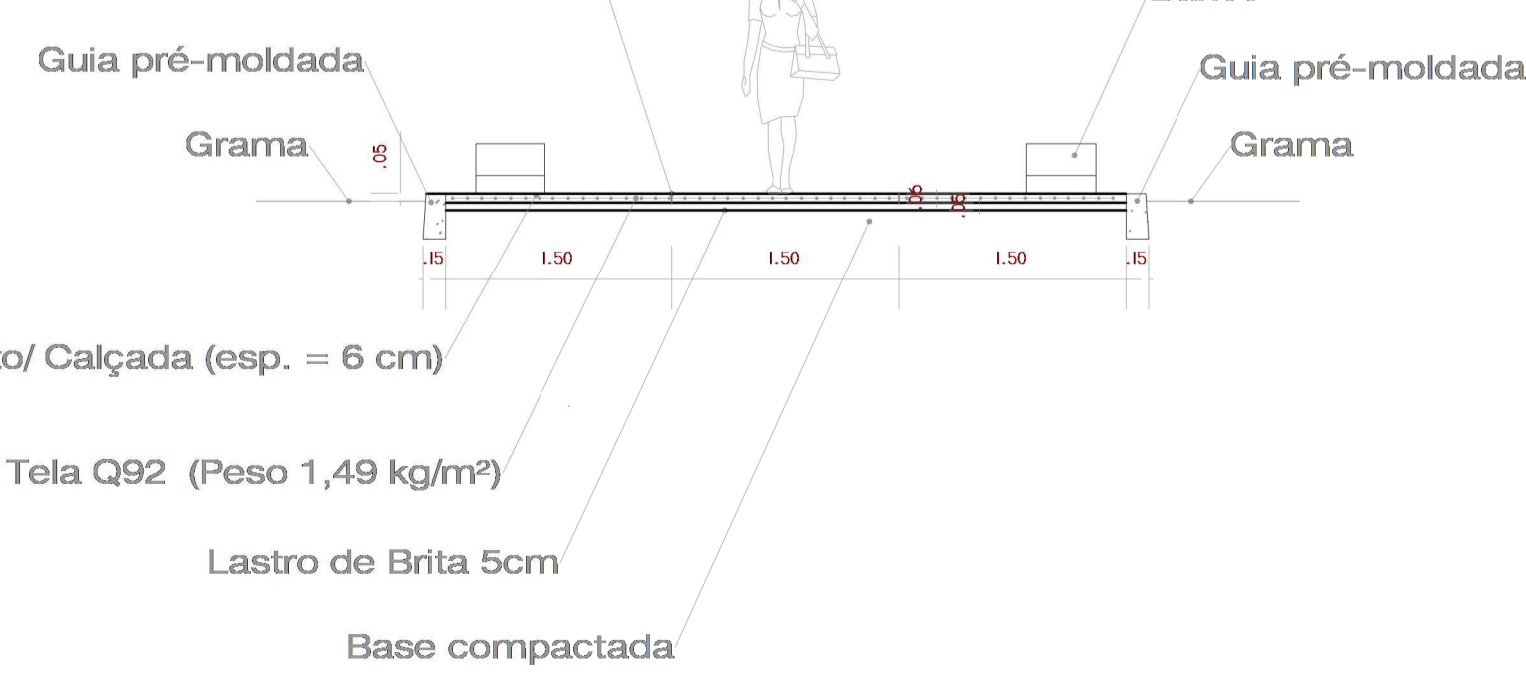
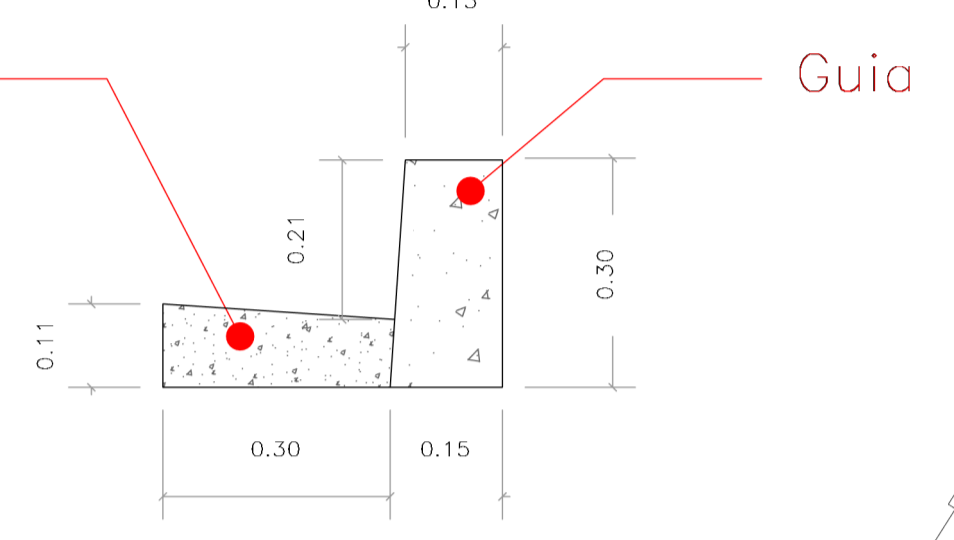

REVITALIZAÇÃO DE PRAÇA NO BAIRRO SANTO ANTÔNIO

FOLHA 3/6

PROJETO DE DEMOLIÇÃO E DE EXECUÇÃO DE GUIAS

LOCAL: CABREÚVA - SP

ENDEREÇO: BAIRRO SANTO ANTÔNIO, RUA SABARÁ

PROPRIETÁRIOS: PREFEITURA MUNICIPAL DE CABREÚVA

SITUAÇÃO SEM ESCALA:

PARQUE SANTO ANTÔNIO

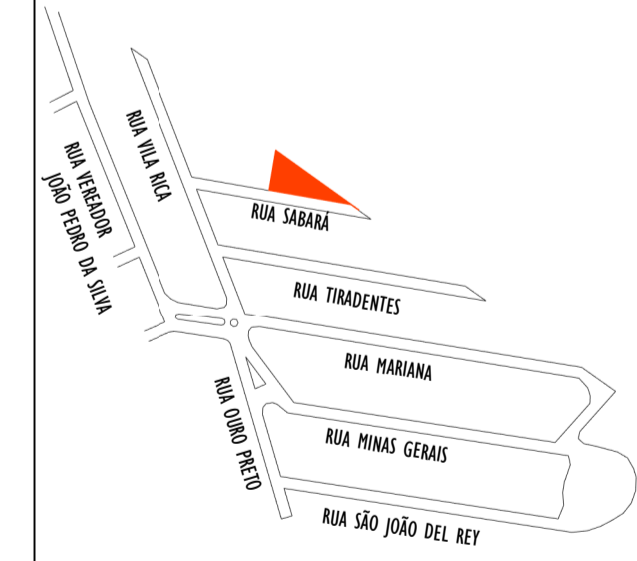

COORDENADAS: -23.25658730355724, -47.056983615209745

PROPRIETÁRIA: PREFEITURA MUNICIPAL DE CABREÚVA  
RESPONSÁVEL: ENGENHEIRO CIVIL - CREA -

RESPONSÁVEL TÉCNICO: ALESSANDRO DA SILVA SILVEIRO  
ENGENHEIRO CIVIL - CREA - 506496947-4 - SP  
NOVELLI ENGENHARIA LTDA

AUTOR DO PROJETO: THALES MARIN  
ARQUITETO URBANISTA - CAU - A112043-0

CARIMBOS: